

ALFA 159 1.9 JTD 16V STALK UNIT ASSEMBLY - R+R 5550A10

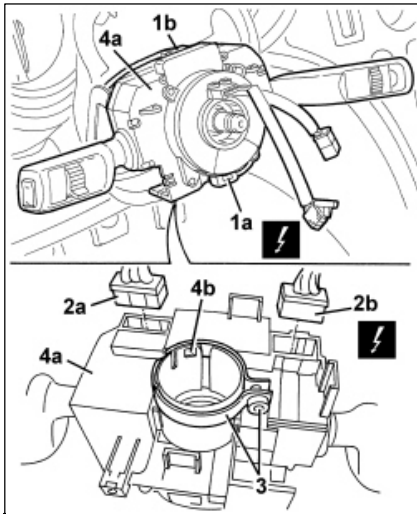

Removing ([Refitting](#))

Op. 7040A26 STEERING COLUMN TRIM - R+R

Follow the safety instructions for this operation meticulously

Op. 5580C18 AIR BAG MODULE - R+R

- Place the steering wheel in a central position with the wheels straight.

Op. 4110A10 STEERING WHEEL - R+R FOR REPLACEMENT OR CHECKS

1. Disconnect the electrical connection for the clock spring (1a) and the steering sensor (1b).

Description	Component
CLOCK SPRING COUPLING	See D047 CLOCK SPRING COUPLING
STEERING SENSOR	See K058 STEERING SENSOR

2. Disconnect the electrical connections (2a, 2b, 2c).

Description	Component
STEERING COLUMN SWITCH UNIT	See H005 STEERING COLUMN SWITCH UNIT

3. Loosen the steering column switch unit retaining band.

4. Remove the steering column switch unit assembly (4a) releasing the tab (4b) from the steering column retainer.

Neither the clock spring, nor the steering angle sensor, nor the Cruise Control system control can be separated from the steering column switch unit. Avoid carrying out operations on the individual components.

Refitting ([Removing](#))

- Check that the steering column switch unit is not damaged.

- Check that the wheels are straight.

- Fit the steering column switch unit assembly in place and attach the tab to the steering column retainer.

- Tighten the steering column switch unit retaining band.

- Connect the front and rear electrical connections for the steering column switch unit.

Op. 4110A10 STEERING WHEEL - R+R FOR REPLACEMENT OR CHECKS

Op. 5580C18 AIR BAG MODULE - R+R

Op. 7040A26 STEERING COLUMN TRIM - R+R